

ISO A couplings made to the ISO 7241:2014 Series A Standard

• IA, IAZ SERIES

INTRODUCTION

IA Series ISO A couplings are the ideal choice where a tough, durable product of superior quality is required. They are perfectly suited to agricultural and industrial applications.

CONSTRUCTION

- Carbon steel with trivalent plating (Zinc nickel plating available)
- Fitted with NBR seals (FKM seals available)
- Also available in AISI 316 stainless steel (See IAS Series)
- Also available in Ford style

FEATURES

- Optional zinc nickel plating provides corrosion resistance (1200 hours with no red rust in salt spray tests)
- Poppet valves have balanced springs
- Locking ball system allows quick connection
- Bidirectional flow

ACCESSORIES

- Dust caps, plugs, parking stations and seal kits are available for the IA Series



SPECIFICATIONS

- OPERATING TEMPERATURES (WITH NBR SEALS): -40°C (-40°F) TO 106°C (223°F), (WITH FKM SEALS): -20°C (-4°F) TO 200°C (392°F)

APPLICATIONS

- AGRICULTURAL
- MOBILE
- CONSTRUCTION
- GENERAL HYDRAULICS

IA, IAZ, PERFORMANCE CHARACTERISTICS

Body Size	IA06	IA10	IA12	IA19	IA25	IA32	IA40	IA50
	Pressure in bar - Flow in LPM							
	Pressure in PSI - Flow in GPM							
Maximum working pressure (Coupled)	400	350	320	300	250	250	230	170
	5800	5075	4640	4350	3625	3625	3335	2465
Burst pressure (Coupled)	2200	1800	1500	1300	1200	1200	1000	800
	31900	26100	21750	18850	17400	17400	14500	11600
Burst pressure (Male)	1900	1700	1500	1300	1100	1200	1000	800
	27550	24650	21750	18850	15950	17400	14500	11600
Burst pressure (Female)	1800	1600	1400	1200	1000	1150	900	750
	26100	23200	20300	17400	14500	16675	13050	10875
Rated flow	3	23	45	106	189	288	379	757
	0.8	6.1	12	28	50	76	100	200

ISO A COUPLINGS MADE TO THE ISO 7241:2014 SERIES A STANDARD

• IA, IAZ SERIES

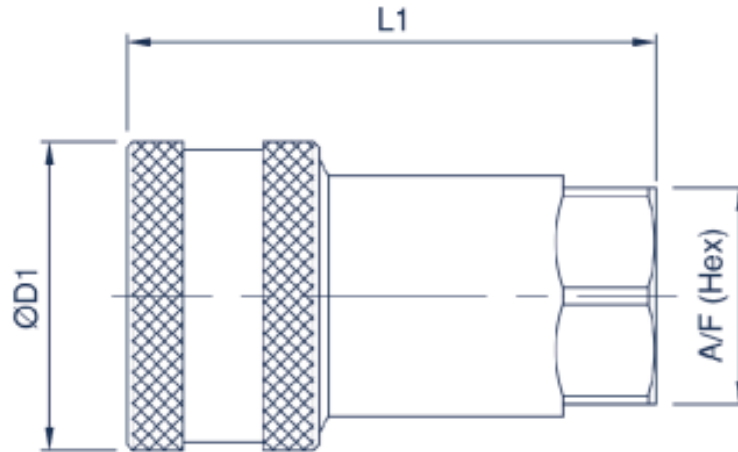

IA, IAZ FEMALE COUPLING

Body Size	Part Number	Thread Size	D1		L1		A/F	
			mm	inch	mm	inch	mm	inch
06 (1/4)	IA06-F-04G	1/4 BSPP	26.0	1.02	50.0	1.79	19.0	0.75
	IA06-F-04N	1/4 NPTF	26.0	1.02	50.0	1.79	19.0	0.75
	IA06-F-04S	7/16-20 UNF	26.0	1.02	50.0	1.79	19.0	0.75
10 (3/8)	IA10-F-06G	3/8 BSPP	31.5	1.24	56.0	2.21	22.0	0.87
	IA10-F-06N	3/8 NPTF	31.5	1.24	56.0	2.21	22.0	0.87
	IA10-F-06S	9/16-18 UNF	31.5	1.24	56.0	2.21	22.0	0.87
12 (1/2)	IA12-F-08G	1/2 BSPP	38.6	1.52	66.3	2.61	27.0	1.06
	IA12-F-08N	1/2 NPTF	38.6	1.52	66.3	2.61	27.0	1.06
	IA12-F-08S	3/4-16 UNF	38.6	1.52	66.3	2.61	27.0	1.06
	IA12-F-10S	7/8-14 UNF	38.6	1.52	66.3	2.61	27.0	1.06
	IA12-F-12N	3/4 NPTF	38.6	1.52	66.3	2.61	32.0	1.26
19 (3/4)	IA19-F-12G	3/4 BSPP	48.0	1.89	80.2	3.16	34.0	1.34
	IA19-F-12N	3/4 NPTF	48.0	1.89	80.2	3.16	34.0	1.34
	IA19-F-12S	1 1/16-12 UN	48.0	1.89	80.2	3.16	34.0	1.34
25 (1)	IA25-F-16G	1 BSPP	56.0	2.20	94.2	3.71	41.0	1.61
	IA25-F-16N	1 NPTF	56.0	2.20	94.2	3.71	41.0	1.61
	IA25-F-16S	1 5/16-12 UN	56.0	2.20	94.2	3.71	41.0	1.61
32 (1 1/4)	IA32-F-20G	1 1/4 BSPP	69.4	2.73	117.1	4.61	50.0	1.97
	IA32-F-20N	1 1/4 NPTF	69.4	2.73	117.1	4.61	50.0	1.97
40 (1 1/2)	IA40-F-24G	1 1/2 BSPP	84.0	3.31	133.0	5.24	60.0	2.36
	IA40-F-24N	1 1/2 NPTF	84.0	3.31	133.0	5.24	60.0	2.36
50 (2)	IA50-F-32G	2 BSPP	99.0	3.90	165.0	6.50	75.0	2.95
	IA50-F-32N	2 NPTF	99.0	3.90	165.0	6.50	75.0	2.95

ISO A COUPLINGS MADE TO THE ISO 7241:2014 SERIES A STANDARD

• IA, IAZ SERIES

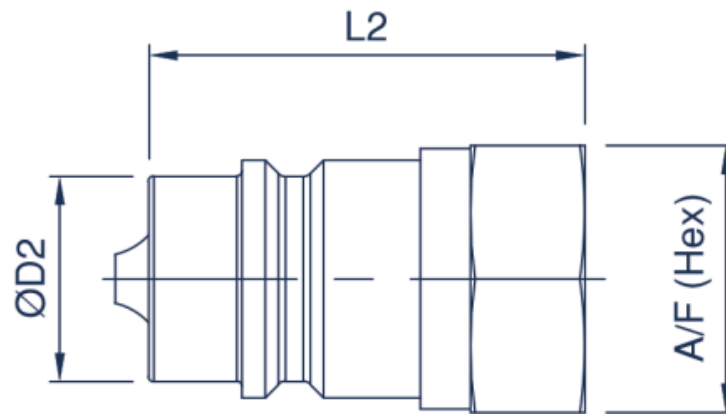

IA, IAZ MALE COUPLING

Body Size	Part Number	Thread Size	D2		L2		A/F	
			mm	inch	mm	inch	mm	inch
06 (1/4)	IA06-M-04G	1/4 BSPP	11.8	0.46	35.5	1.40	19.0	0.75
	IA06-M-04N	1/4 NPTF	11.8	0.46	35.5	1.40	19.0	0.75
	IA06-M-04S	7/16-20 UNF	11.8	0.46	35.5	1.40	19.0	0.75
10 (3/8)	IA10-M-06G	3/8 BSPP	17.3	0.68	36.5	1.44	22.0	0.87
	IA10-M-06N	3/8 NPTF	17.3	0.68	36.5	1.44	22.0	0.87
	IA10-M-06S	9/16-18 UNF	17.3	0.68	36.5	1.44	22.0	0.87
12 (1/2)	IA12-M-08G	1/2 BSPP	20.5	0.81	43.5	1.71	27.0	1.06
	IA12-M-08N	1/2 NPTF	20.5	0.81	43.5	1.71	27.0	1.06
	IA12-M-08S	3/4-16 UNF	20.5	0.81	43.5	1.71	27.0	1.06
	IA12-M-10S	7/8-14 UNF	20.5	0.81	43.5	1.71	27.0	1.06
	IA12-M-12N	3/4 NPTF	20.5	0.81	43.5	1.71	27.0	1.06
19 (3/4)	IA19-M-12G	3/4 BSPP	29.1	1.14	57.0	2.24	35.0	1.38
	IA19-M-12N	3/4 NPTF	29.1	1.14	57.0	2.24	35.0	1.38
	IA19-M-12S	1 1/16-12 UN	29.1	1.14	57.0	2.24	35.0	1.38
25 (1)	IA25-M-16G	1 BSPP	34.3	1.35	59.5	2.34	41.0	1.61
	IA25-M-16N	1 NPTF	34.3	1.35	59.5	2.34	41.0	1.61
	IA25-M-16S	1 5/16-12 UN	34.3	1.35	59.5	2.34	41.0	1.61
32 (1 1/4)	IA32-M-20G	1 1/4 BSPP	45.0	1.77	75.0	2.95	50.0	1.97
	IA32-M-20N	1 1/4 NPTF	45.0	1.77	75.0	2.95	50.0	1.97
40 (1 1/2)	IA40-M-24G	1 1/2 BSPP	55.0	2.16	83.5	3.29	60.0	2.36
	IA40-M-24N	1 1/2 NPTF	55.0	2.16	83.5	3.29	60.0	2.36
50 (2)	IA50-M-32G	2 BSPP	65.1	2.56	105.0	4.13	75.0	2.95
	IA50-M-32N	2 NPTF	65.1	2.56	105.0	4.13	75.0	2.95