

*ISO A couplings made to the ISO 7241:2014 Series B Standard*

**• IBB SERIES**

**INTRODUCTION**

IBB Series brass ISO B couplings incorporate all the benefits of the carbon steel IB Series couplings whilst providing good corrosion resistance for specific applications.



**CONSTRUCTION**

- Brass body
- AISI 304 spring and AISI 304 locking ball
- Fitted with FKM seals
- Also available in carbon steel (See IB Series)
- Also available in AISI 316 stainless steel (See IBS Series)

**FEATURES**

- Poppet valves have balanced springs
- Locking ball system allows quick connection
- Bidirectional flow

**ACCESSORIES**

- Dust caps, plugs and seal kits are available for the IBB Series

**SPECIFICATIONS**

- OPERATING TEMPERATURES (WITH FKM SEALS): -20°C (-4°F) TO 200°C (392°F)

**APPLICATIONS**

- COOLING SYSTEMS
- MARINE
- OFFSHORE/ONSHORE
- CHEMICAL
- PHARMACEUTICAL

**IBB PERFORMANCE CHARACTERISTICS**

Body Size	IBB04	IBB06	IBB10	IBB12	IBB19	IBB25
	Pressure in bar - Flow in LPM					
	Pressure in PSI - Flow in GPM					
Maximum working pressure (Coupled)	210 3046	210 3046	180 2611	180 2611	140 2031	140 2031
Burst pressure (Coupled)	2300 33350	1750 25375	1500 21750	1320 19140	1200 17400	1150 16675
Burst pressure (Male)	1900 27550	1700 24650	1500 21750	1350 19575	1300 18850	1060 15370
Burst pressure (Female)	1950 28275	1800 26100	1550 22475	1400 20300	1350 19575	1100 15950
Rated flow	3 0.8	12 3.2	23 6	45 12	106 28	189 50

ISO A COUPLINGS MADE TO THE ISO 7241:2014 SERIES B STANDARD

• IBB SERIES

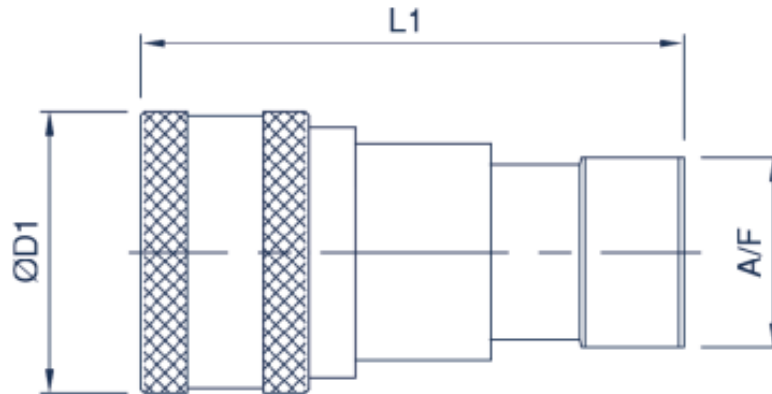

**IBB FEMALE COUPLING**

Body Size	Part Number	Thread Size	D1		L1		A/F	
			mm	inch	mm	inch	mm	inch
04 (1/8)	IBB04-F-02G	1/8 BSPP	24.0	0.94	48.0	1.89	14.0	0.55
	IBB04-F-02N	1/8 NPTF	24.0	0.94	48.0	1.89	14.0	0.55
	IBB04-F-04S	7/16-20 UNF	24.0	0.94	48.0	1.89	14.0	0.55
06 (1/4)	IBB06-F-04G	1/4 BSPP	28.5	1.12	58.0	2.28	19.0	0.75
	IBB06-F-04N	1/4 NPTF	28.5	1.12	58.0	2.28	19.0	0.75
	IBB06-F-06S	9/16-18 UNF	28.5	1.12	58.0	2.28	19.0	0.75
10 (3/8)	IBB10-F-06G	3/8 BSPP	35.0	1.38	65.0	2.56	24.0	0.95
	IBB10-F-06N	3/8 NPTF	35.0	1.38	65.0	2.56	24.0	0.95
	IBB10-F-06S	9/16-18 UNF	35.0	1.38	65.0	2.56	24.0	0.95
	IBB10-F-08S	3/4-16 UN	35.0	1.38	69.0	2.72	24.0	0.95
12 (1/2)	IBB12-F-08G	1/2 BSPP	44.5	1.75	74.0	2.91	28.5	1.12
	IBB12-F-08N	1/2 NPTF	44.5	1.75	74.0	2.91	28.5	1.12
	IBB12-F-08S	3/4-16 UNF	44.5	1.75	74.0	2.91	28.5	1.12
	IBB12-F-10S	7/8-14 UNF	44.5	1.75	74.0	2.91	28.5	1.12
19 (3/4)	IBB19-F-12G	3/4 BSPP	54.0	2.13	92.0	3.62	36.0	1.42
	IBB19-F-12N	3/4 NPTF	54.0	2.13	92.0	3.62	36.0	1.42
	IBB19-F-12S	1 1/16-12 UN	54.0	2.13	92.0	3.62	36.0	1.42
25 (1)	IBB25-F-16G	1 BSPP	64.0	2.52	103.0	4.06	41.0	1.61
	IBB25-F-16N	1 NPTF	64.0	2.52	103.0	4.06	41.0	1.61
	IBB25-F-16S	1 5/16-12 UN	64.0	2.52	103.0	4.06	41.0	1.61
40 (1 1/2)	IBB40-F-20G	1 1/4 BSPP	73.5	2.89	124.0	4.88	65.0	2.56
	IBB40-F-20N	1 1/4 NPTF	73.5	2.89	124.0	4.88	65.0	2.56
	IBB40-F-24G	1 1/2 BSPP	73.5	2.89	124.0	4.88	65.0	2.56
	IBB40-F-24N	1 1/2 NPT	73.5	2.89	124.0	4.88	65.0	2.56
50 (2)	IBB50-F-32G	2 BSPP	101.0	3.98	141.5	5.57	90.0	3.54
	IBB50-F-32N	2 NPTF	101.0	3.98	141.5	5.57	90.0	3.54

\*For all other configurations or thread types please contact the sales office.

ISO A COUPLINGS MADE TO THE ISO 7241:2014 SERIES B STANDARD

• IBB SERIES

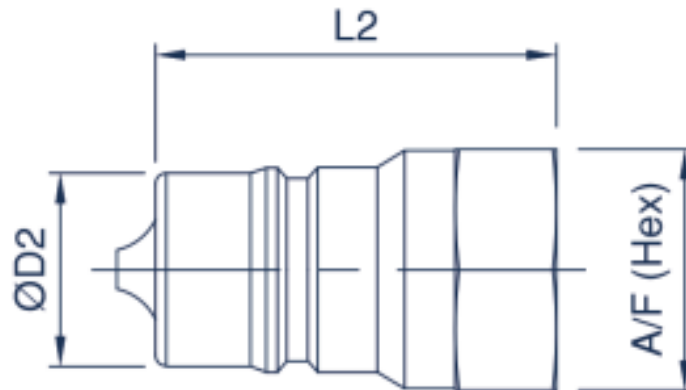

**IBB MALE COUPLING**

Body Size	Part Number	Thread Size	D2		L2		A/F	
			mm	inch	mm	inch	mm	inch
04 (1/8)	IBB04-M-02G	1/8 BSPP	10.9	0.43	29.0	1.14	17.0	0.67
	IBB04-M-02N	1/8 NPTF	10.9	0.43	29.0	1.14	17.0	0.67
	IBB04-M-04S	7/16-20 UNF	10.9	0.43	29.0	1.14	17.0	0.67
06 (1/4)	IBB06-M-04G	1/4 BSPP	14.2	0.56	36.0	1.42	19.0	0.75
	IBB06-M-04N	1/4 NPTF	14.2	0.56	36.0	1.42	19.0	0.75
	IBB06-M-06S	9/16-18 UNF	14.2	0.56	36.0	1.42	19.0	0.75
10 (3/8)	IBB10-M-06G	3/8 BSPP	19.1	0.75	40.0	1.57	24.0	0.95
	IBB10-M-06N	3/8 NPTF	19.1	0.75	40.0	1.57	24.0	0.95
	IBB10-M-06S	9/16-18 UNF	19.1	0.75	40.0	1.57	24.0	0.95
	IBB10-M-08S	3/4-16 UN	19.1	0.75	44.0	1.73	24.0	0.95
12 (1/2)	IBB12-M-08G	1/2 BSPP	23.5	0.93	46.5	1.83	28.5	1.12
	IBB12-M-08N	1/2 NPTF	23.5	0.93	46.5	1.83	28.5	1.12
	IBB12-M-08S	3/4-16 UNF	23.5	0.93	46.5	1.83	28.5	1.12
	IBB12-M-10S	7/8-14 UNF	23.5	0.93	46.5	1.83	28.5	1.12
19 (3/4)	IBB19-M-12G	3/4 BSPP	31.4	1.24	56.0	2.20	36.0	1.42
	IBB19-M-12N	3/4 NPTF	31.4	1.24	56.0	2.20	36.0	1.42
	IBB19-M-12S	1 1/16-12 UN	31.4	1.24	56.0	2.20	36.0	1.42
25 (1)	IBB25-M-16G	1 BSPP	37.8	1.49	63.0	2.48	41.0	1.61
	IBB25-M-16N	1 NPTF	37.8	1.49	63.0	2.48	41.0	1.61
	IBB25-M-16S	1 5/16-12 UN	37.8	1.49	63.0	2.48	41.0	1.61
40 (1 1/2)	IBB40-M-20G	1 1/4 BSPP	44.5	1.75	122.0	4.80	65.0	2.56
	IBB40-M-20N	1 1/4 NPTF	44.5	1.75	122.0	4.80	65.0	2.56
	IBB40-M-24G	1 1/2 BSPP	44.5	1.75	122.0	4.80	65.0	2.56
	IBB40-M-24N	1 1/2 NPTF	44.5	1.75	122.0	4.80	65.0	2.56
50 (2)	IBB50-M-32G	2 BSPP	63.2	2.49	139.2	5.48	90.0	3.54
	IBB50-M-32N	2 NPTF	63.2	2.49	139.2	5.48	90.0	3.54

\*For all other configurations or thread types please contact the sales office.