

## Screw to connect high pressure heavy duty couplings

### • PTS SERIES

#### INTRODUCTION

PTS Series stainless steel screw to connect couplings are designed for heavy duty applications involving very high pressures and severe pressure pulses. They incorporate all the benefits of the carbon steel PTC Series, whilst being perfectly suited for corrosive fluids and environments.



#### CONSTRUCTION

- AISI 316 stainless steel
- Fitted with FKM seals (Other seals available on request)
- Also available in carbon steel (See PTC Series)

#### FEATURES

- Can be connected with 50 bar (735 psi) residual pressure in the hydraulic circuit
- Bidirectional flow

#### ACCESSORIES

- Dust caps, plugs and seal kits are available for the PTS Series

#### SPECIFICATIONS

- Operating temperatures (With FKM seals): -20°C (-4°F) to 200°C (392°F)

#### APPLICATIONS

- Hydraulic jacks
- Marine
- Offshore/onshore

### PTS PERFORMANCE CHARACTERISTICS

Body Size	PTS06	PTS10	PTS12	PTS19	PTS25	PTS32	PTS40	PTS50
	Pressure in bar - Flow in LPM Pressure in PSI - Flow in GPM							
Maximum working pressure (Coupled)	700 10150	650 9425	600 8700	500 7250	460 6670	380 5510	365 5292	300 4350
Burst pressure (Coupled)	3700 53650	2600 37700	2500 36250	2400 34800	1500 21750	1000 14500	1000 14500	900 13050
Burst pressure (Male)	3700 53650	2300 33350	2100 30450	2100 30450	1600 23200	1000 14500	900 13050	900 13050
Burst pressure (Female)	3800 55100	2000 29000	2700 39150	1700 24650	1900 27550	1000 14500	950 13775	900 13050
Rated flow	3 0.8	23 6.1	45 12	106 28	189 50	288 76	379 100	757 200

**SCREW TO CONNECT HIGH PRESSURE HEAVY DUTY COUPLINGS**

**• PTS SERIES**

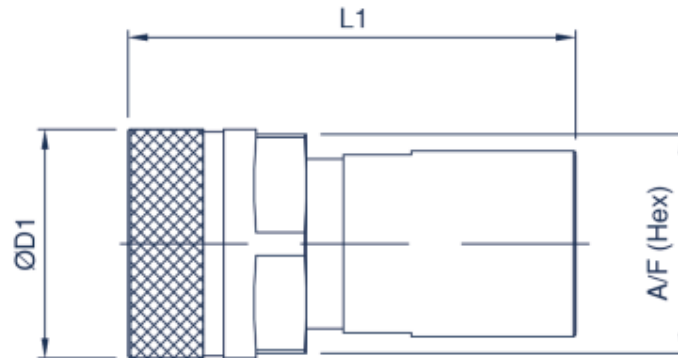

**PTS FEMALE COUPLING**

Body Size	Part Number	Thread Size	D1		L1		A/F	
			mm	inch	mm	inch	mm	inch
06 (1/4)	PTS06-F-04G	1/4 BSPP	30.0	1.18	61.5	2.42	27.0	1.06
	PTS06-F-04N	1/4 NPTF	30.0	1.18	61.5	2.42	27.0	1.06
	PTS06-F-06S	9/16-18 UNF	30.0	1.18	61.5	2.42	27.0	1.06
10 (3/8)	PTS10-F-06G	3/8 BSPP	39.0	1.54	69.0	2.72	36.0	1.42
	PTS10-F-06N	3/8 NPTF	39.0	1.54	69.0	2.72	36.0	1.42
	PTS10-F-06S	9/16-18 UNF	39.0	1.54	69.0	2.72	36.0	1.42
12 (1/2)	PTS12-F-08G	1/2 BSPP	44.0	1.73	79.0	3.11	41.0	1.61
	PTS12-F-08N	1/2 NPTF	44.0	1.73	79.0	3.11	41.0	1.61
	PTS12-F-08S	3/4-16 UNF	44.0	1.73	79.0	3.11	41.0	1.61
19 (3/4)	PTS19-F-12G	3/4 BSPP	54.0	2.13	97.5	3.84	50.0	1.97
	PTS19-F-12N	3/4 NPTF	54.0	2.13	97.5	3.84	50.0	1.97
	PTS19-F-12S	1 1/16-12 UN	54.0	2.13	97.5	3.84	50.0	1.97
25 (1)	PTS25-F-16G	1 BSPP	59.0	2.32	112.5	4.43	54.5	2.15
	PTS25-F-16N	1 NPTF	59.0	2.32	112.5	4.43	54.5	2.15
	PTS25-F-16S	1 5/16-12 UN	59.0	2.32	112.5	4.43	54.5	2.15
32 (1 1/4)	PTS32-F-20G	1 1/4 BSPP	80.0	3.15	139.5	5.49	74.5	2.93
	PTS32-F-20N	1 1/4 NPTF	80.0	3.15	139.5	5.49	74.5	2.93
	PTS32-F-20S	1 5/8-12 UN	80.0	3.15	139.5	5.49	74.5	2.93
40 (1 1/2)	PTS40-F-24G	1 1/2 BSPP	98.0	3.86	172.0	6.77	90.0	3.54
	PTS40-F-24N	1 1/2 NPTF	98.0	3.86	172.0	6.77	90.0	3.54
	PTS40-F-24S	1 7/8-12 UN	98.0	3.86	172.0	6.77	90.0	3.54
50 (2)	PTS50-F-32G	2 BSPP	127.5	5.02	160.0	6.30	123.0	4.84
	PTS50-F-32N	2 NPTF	127.5	5.02	160.0	6.30	123.0	4.84
	PTS50-F-32S	2 1/2-12 UN	127.5	5.02	160.0	6.30	123.0	4.84

\*For all other configurations or thread types please contact the sales office.

**SCREW TO CONNECT HIGH PRESSURE HEAVY DUTY COUPLINGS**

**• PTS SERIES**

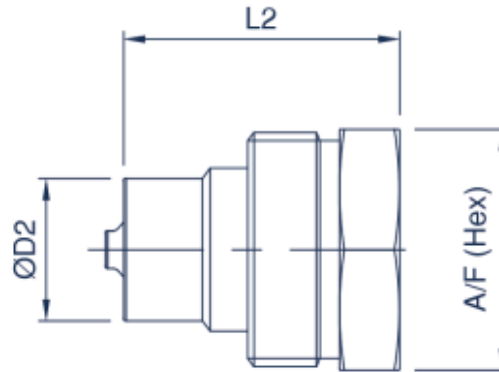

**PTS MALE COUPLING**

Body Size	Part Number	Thread Size	D2		L2		A/F	
			mm	inch	mm	inch	mm	inch
<b>06 (1/4)</b>	PTS06-M-04G	1/4 BSPP	14.2	0.56	43.0	1.69	25.0	0.98
	PTS06-M-04N	1/4 NPTF	14.2	0.56	43.0	1.69	25.0	0.98
	PTS06-M-06S	9/16-18 UNF	14.2	0.56	43.0	1.69	25.0	0.98
<b>10 (3/8)</b>	PTS10-M-06G	3/8 BSPP	19.0	0.75	48.5	1.91	32.0	1.26
	PTS10-M-06N	3/8 NPTF	19.0	0.75	48.5	1.91	32.0	1.26
	PTS10-M-06S	9/16-18 UNF	19.0	0.75	48.5	1.91	32.0	1.26
<b>12 (1/2)</b>	PTS12-M-08G	1/2 BSPP	20.5	0.81	53.0	2.09	34.0	1.34
	PTS12-M-08N	1/2 NPTF	20.5	0.81	53.0	2.09	34.0	1.34
	PTS12-M-08S	3/4-16 UNF	20.5	0.81	53.0	2.09	34.0	1.34
<b>19 (3/4)</b>	PTS19-M-12G	3/4 BSPP	28.0	1.10	63.0	2.48	46.0	1.81
	PTS19-M-12N	3/4 NPTF	28.0	1.10	63.0	2.48	46.0	1.81
	PTS19-M-12S	1 1/16-12 UN	28.0	1.10	63.0	2.48	46.0	1.81
<b>25 (1)</b>	PTS25-M-16G	1 BSPP	31.3	1.23	72.5	2.85	50.0	1.97
	PTS25-M-16N	1 NPTF	31.3	1.23	72.5	2.85	50.0	1.97
	PTS25-M-16S	1 5/16-12 UN	31.3	1.23	72.5	2.85	50.0	1.97
<b>32 (1 1/4)</b>	PTS32-M-20G	1 1/4 BSPP	44.0	1.73	86.0	3.39	65.0	2.56
	PTS32-M-20N	1 1/4 NPTF	44.0	1.73	86.0	3.39	65.0	2.56
	PTS32-M-20S	1 5/8-12 UN	44.0	1.73	86.0	3.39	65.0	2.56
<b>40 (1 1/2)</b>	PTS40-M-24G	1 1/2 BSPP	53.5	2.11	95.0	3.74	80.0	3.15
	PTS40-M-24N	1 1/2 NPTF	53.5	2.11	95.0	3.74	80.0	3.15
	PTS40-M-24S	1 7/8-12 UN	53.5	2.11	95.0	3.74	80.0	3.15
<b>50 (2)</b>	PTS50-M-32G	2 BSPP	82.0	3.23	118.5	4.67	110.0	4.33
	PTS50-M-32N	2 NPTF	82.0	3.23	118.5	4.67	110.0	4.33
	PTS50-M-32S	2 1/2-12 UN	82.0	3.23	118.5	4.67	110.0	4.33

\*For all other configurations or thread types please contact the sales office.