

Flat face couplings made to the ISO 16028 Standard

• HQ SERIES

INTRODUCTION

The HQ Series flat face couplings are Creative's flagship products, known globally for their leak free performance across multiple applications. The preferred choice for many global OEMs.



CONSTRUCTION

- Carbon steel with zinc nickel plating (1200 hours with no red rust in salt spray tests)
- Fitted with NBR seals (FKM seals available)
- Also available in AISI 316 stainless steel (See HSS Series)

FEATURES

- Safety locking sleeve fitted as standard to prevent accidental disconnection
- Flat faces are easily wiped clean
- Minimal inclusion of air and contaminants during connection
- Flat face design prevents fluid loss during disconnection
- Bidirectional flow

ACCESSORIES

- Dust caps are available for the HQ Series

SPECIFICATIONS

- OPERATING TEMPERATURES (WITH NBR SEALS): -40°C (-40°F) TO 106°C (223°F), (WITH FKM SEALS): -20°C (-4°F) TO 200°C (392°F)
- COUPLINGS HAVE BEEN TESTED TO THE ISO 18869 STANDARD

APPLICATIONS

- HIGH PRESSURE PULSE APPLICATIONS
- LEAK FREE ENVIRONMENTS
- CONSTRUCTION PLANT
- MOBILE EQUIPMENT
- GENERAL INDUSTRIAL
- AGRICULTURAL
- SKID STEER LOADERS

HQ PERFORMANCE CHARACTERISTICS

Body Size	HQ04	HQ06	HQ10	HQ12	HQ16	HQ19	HQ25	HQ32	HQ40
	Pressure in bar - Flow in LPM								
	Pressure in PSI - Flow in GPM								
Maximum working pressure (Coupled)	450	400	375	350	350	350	315	250	250
	6525	5800	5438	5075	5075	5075	4568	3625	3625
Burst pressure (Coupled)	1750	1600	1550	1400	1500	1450	1000	1100	1000
	25380	23200	22475	20300	21750	21025	14500	15950	14500
Burst pressure (Male)	1750	1850	1200	1300	1200	1100	1000	1200	1000
	25380	26825	17400	18850	17400	15950	14500	17400	14500
Burst pressure (Female)	1750	1220	1050	1000	1050	1050	1000	1200	1000
	25380	17690	15225	14500	15225	15225	14500	17400	14500
Rated flow	3	12	23	45	74	100	189	250	379
	0.8	3.2	6.1	12	19.5	26.4	50	66	100

FLAT FACE COUPLINGS MADE TO THE ISO 16028 STANDARD

• HQ SERIES

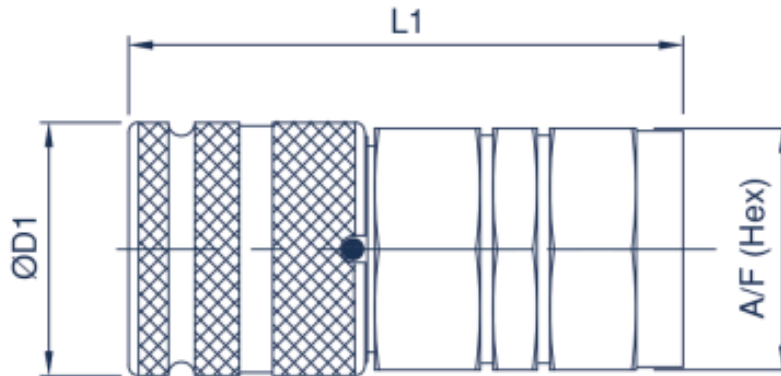

HQ FEMALE COUPLING

Body Size	Part Number	Thread Size	D1		L1		A/F	
			mm	inch	mm	inch	mm	inch
04 (1/8)	HQ04-F-02G	1/8 BSPP	20.4	0.80	40.2	1.58	17.0	0.67
	HQ04-F-02N	1/8 NPTF	20.4	0.80	40.2	1.58	17.0	0.67
	HQ04-F-04S	7/16-20 UNF	20.4	0.80	40.2	1.58	17.0	0.67
06 (1/4)	HQ06-F-04G	1/4 BSPP	28.0	1.10	54.0	2.13	27.0	1.06
	HQ06-F-04N	1/4 NPTF	28.0	1.10	54.0	2.13	27.0	1.06
	HQ06-F-06S	9/16-18 UNF	28.0	1.10	54.0	2.13	27.0	1.06
10 (3/8)	HQ10-F-06G	3/8 BSPP	32.0	1.26	69.0	2.72	30.0	1.18
	HQ10-F-06N	3/8 NPTF	32.0	1.26	69.0	2.72	30.0	1.18
	HQ10-F-06S	9/16-18 UNF	32.0	1.26	69.0	2.72	30.0	1.18
	HQ10-F-08G	1/2 BSPP	32.0	1.26	74.0	2.91	30.0	1.18
	HQ10-F-08N	1/2 NPTF	32.0	1.26	74.0	2.91	30.0	1.18
	HQ10-F-08S	3/4-16 UNF	32.0	1.26	74.0	2.91	30.0	1.18
12 (1/2)	HQ12-F-08G	1/2 BSPP	38.0	1.50	83.8	3.30	36.0	1.42
	HQ12-F-08N	1/2 NPTF	38.0	1.50	83.8	3.30	36.0	1.42
	HQ12-F-08S	3/4-16 UNF	38.0	1.50	83.8	3.30	36.0	1.42
	HQ12-F-10S	7/8-14 UNF	38.0	1.50	83.8	3.30	36.0	1.42
	HQ12-F-12G	3/4 BSPP	38.0	1.50	83.8	3.30	36.0	1.42
	HQ12-F-12N	3/4 NPTF	38.0	1.50	83.8	3.30	36.0	1.42
16 (5/8)	HQ12-F-12S	1 1/16-12 UN	38.0	1.50	83.8	3.30	36.0	1.42
	HQ16-F-12G	3/4 BSPP	42.0	1.65	83.8	3.30	41.0	1.61
	HQ16-F-12N	3/4 NPTF	42.0	1.65	83.8	3.30	41.0	1.61
	HQ16-F-12S	1 1/16-12 UN	42.0	1.65	83.8	3.30	41.0	1.61
19 (3/4)	HQ19-F-12G	3/4 BSPP	48.0	1.89	99.0	3.90	46.0	1.81
	HQ19-F-12N	3/4 NPTF	48.0	1.89	99.0	3.90	46.0	1.81
	HQ19-F-12S	1 1/16-12 UN	48.0	1.89	99.0	3.90	46.0	1.81
	HQ19-F-16G	1 BSPP	48.0	1.89	99.0	3.90	46.0	1.81
	HQ19-F-16N	1 NPTF	48.0	1.89	99.0	3.90	46.0	1.81
25 (1)	HQ19-F-16S	1 5/16-12 UN	48.0	1.89	99.0	3.90	46.0	1.81
	HQ25-F-16G	1 BSPP	55.0	2.17	108.5	4.27	55.0	2.17
	HQ25-F-16N	1 NPTF	55.0	2.17	108.5	4.27	55.0	2.17
	HQ25-F-16S	1 5/16-12 UN	55.0	2.17	108.5	4.27	55.0	2.17
	HQ25-F-20G	1 1/4 BSPP	55.0	2.17	111.5	4.39	55.0	2.17
	HQ25-F-20N	1 1/4 NPTF	55.0	2.17	111.5	4.39	55.0	2.17
32 (1 1/4)	HQ25-F-20S	1 5/8-12 UN	55.0	2.17	111.5	4.39	55.0	2.17
	HQ32-F-24G	1 1/2 BSPP	80.0	3.15	132.2	5.20	70.0	2.76
	HQ32-F-24N	1 1/2 NPTF	80.0	3.15	132.2	5.20	70.0	2.76
40 (1 1/2)	HQ32-F-24S	1 7/8-12 UN	80.0	3.15	132.2	5.20	70.0	2.76
	HQ40-F-32G	2 BSPP	102.8	4.05	147.3	5.80	80.0	3.15
	HQ40-F-32N	2 NPTF	102.8	4.05	147.3	5.80	80.0	3.15
	HQ40-F-32S	2 1/2-12 UN	102.8	4.05	147.3	5.80	80.0	3.15

*For all other configurations or thread types please contact the sales office.

FLAT FACE COUPLINGS MADE TO THE ISO 16028 STANDARD

• HQ SERIES

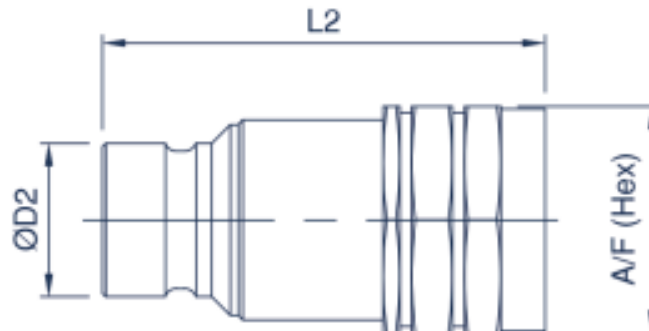

HQ MALE COUPLING

Body Size	Part Number	Thread Size	D2		L2		A/F	
			mm	inch	mm	inch	mm	inch
04 (1/8)	HQ04-M-02G	1/8 BSPP	11.6	0.46	36.5	1.44	17.0	0.67
	HQ04-M-02N	1/8 NPTF	11.6	0.46	36.5	1.44	17.0	0.67
	HQ04-M-04S	7/16-20 UNF	11.6	0.46	36.5	1.44	17.0	0.67
06 (1/4)	HQ06-M-04G	1/4 BSPP	16.1	0.64	53.5	2.11	27.0	1.06
	HQ06-M-04N	1/4NPTF	16.1	0.64	53.5	2.11	27.0	1.06
	HQ06-M-06S	9/16-18 UNF	16.1	0.64	53.5	2.11	27.0	1.06
10 (3/8)	HQ10-M-06G	3/8 BSPP	19.7	0.78	60.0	2.36	27.0	1.06
	HQ10-M-06N	3/8 NPTF	19.7	0.78	60.0	2.36	27.0	1.06
	HQ10-M-06S	9/16-18 UNF	19.7	0.78	60.0	2.36	27.0	1.06
	HQ10-M-08G	1/2 BSPP	19.7	0.78	63.0	2.48	27.0	1.06
	HQ10-M-08N	1/2 NPTF	19.7	0.78	63.0	2.48	27.0	1.06
12 (1/2)	HQ10-M-08S	3/4-16 UNF	19.7	0.78	63.0	2.48	27.0	1.06
	HQ12-M-08G	1/2 BSPP	24.5	0.97	71.0	2.80	36.0	1.42
	HQ12-M-08N	1/2 NPTF	24.5	0.97	71.0	2.80	36.0	1.42
	HQ12-M-08S	3/4-16 UNF	24.5	0.97	71.0	2.80	36.0	1.42
	HQ12-M-10S	7/8-14 UNF	24.5	0.97	71.0	2.80	36.0	1.42
	HQ12-M-12G	3/4 BSPP	24.5	0.97	71.0	2.80	36.0	1.42
16 (5/8)	HQ12-M-12N	3/4 NPTF	24.5	0.97	71.0	2.80	36.0	1.42
	HQ12-M-12S	1 1/16-12 UN	24.5	0.97	71.0	2.80	36.0	1.42
	HQ16-M-12G	3/4 BSPP	27.0	1.06	73.0	2.87	36.0	1.42
	HQ16-M-12N	3/4 NPTF	27.0	1.06	73.0	2.87	36.0	1.42
19 (3/4)	HQ16-M-12S	1 1/16-12 UN	27.0	1.06	73.0	2.87	36.0	1.42
	HQ19-M-12G	3/4 BSPP	29.9	1.18	84.0	3.31	46.0	1.81
	HQ19-M-12N	3/4 NPTF	29.9	1.18	84.0	3.31	46.0	1.81
	HQ19-M-12S	1 1/16-12 UN	29.9	1.18	84.0	3.31	46.0	1.81
	HQ19-M-16G	1 BSPP	29.9	1.18	84.0	3.31	46.0	1.81
25 (1)	HQ19-M-16N	1 NPTF	29.9	1.18	84.0	3.31	46.0	1.81
	HQ19-M-16S	1 5/16-12 UN	29.9	1.18	84.0	3.31	46.0	1.81
	HQ25-M-16G	1 BSPP	36.0	1.42	97.0	3.82	55.0	2.17
	HQ25-M-16N	1 NPTF	36.0	1.42	97.0	3.82	55.0	2.17
	HQ25-M-16S	1 5/16-12 UN	36.0	1.42	97.0	3.82	55.0	2.17
	HQ25-M-20G	1 1/4 BSPP	36.0	1.42	90.4	3.56	55.0	2.17
32 (1 1/4)	HQ25-M-20N	1 1/4 NPTF	36.0	1.42	90.4	3.56	55.0	2.17
	HQ25-M-20S	1 5/8-12 UN	36.0	1.42	90.4	3.56	55.0	2.17
	HQ32-M-24G	1 1/2 BSPP	57.0	2.24	119.7	4.71	70.0	2.76
40 (1 1/2)	HQ32-M-24N	1 1/2 NPTF	57.0	2.24	119.7	4.71	70.0	2.76
	HQ32-M-24S	1 7/8-12 UN	57.0	2.24	119.7	4.71	70.0	2.76
	HQ40-M-32G	2 BSPP	72.9	2.87	173.2	6.82	80.0	3.15
40 (1 1/2)	HQ40-M-32S	2 NPTF	72.9	2.87	173.2	6.82	80.0	3.15
	HQ40-M-32N	2 1/2-12 UN	72.9	2.87	173.2	6.82	80.0	3.15

*For all other configurations or thread types please contact the sales office.